

尺寸：100*140mm

材质：封面200g太阳哑粉；纸内页128g铜版纸过哑油

装订方式：骑马钉

BIZEWO



MULTIFUNCTIONAL JUMP STARTER

JS001 User Manual

www.bizewohome.com

CUSTOMER SERVICE

Our customer service team is always ready to assist you if you have any issues or concerns.

 www.bizewohome.com

 support@bizewohome.com

 1-888-283-6836

PRODUCT DESCRIPTION	01
PRODUCT OVERVIEW	02
HOW TO USE THE PRODUCT	04
OTHER FUNCTIONS	07
MULTIFUNCTIONAL LIGHTING	09
SAFETY INSTRUCTIONS	11
WARNING	13
WARRANTY	15

About

Please read this manual carefully and keep it properly before using this product for the first time. It will guide you to use it correctly and remind you of relevant precautions. This product is a portable car jump starter & power bank & folding lamp. It can start a car whose battery (12V) is losing electricity and can be a mobile power source for mobile phones, tablets, PSPs, MP3/MP4, and cameras etc. Besides, the product also has LED light functions (2 lighting modes, strobe mode, SOS mode, and warning mode).

**Note:**

this product is not a toy, and children are forbidden to use it.

Features



Engine Start



Power Bank



SOS Signal



Outdoor Light



Warning Light

Overview

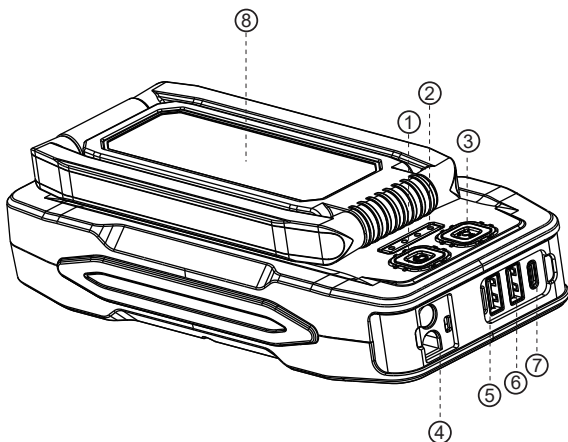

- | | |
|-------------------------|----------------|
| ① Power Button | ⑤ Output 1 |
| ② Power Indicator Light | ⑥ Output 2 |
| ③ LED Light Button | ⑦ Input/Output |
| ④ Car Starting Port | ⑧ LED Light |

Packing List

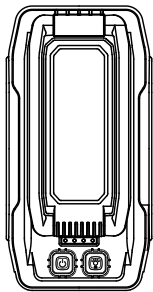

Jump Starterx1



Jump starter clamps x1



Manual x1

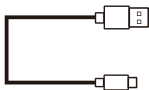

USB-A to USB-C cable x1



Storage bag x1

How to charge the jump start?

Using the USB cable to connect the power adapter with USB-C charging port of the product.

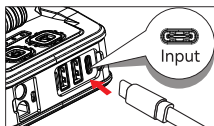

Step1

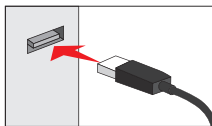

Step2

How to jump start the vehicles?



Note:

Before attempting to jump-start a vehicle, make sure you have turned off all of the power loads of the vehicle, including headlights, radio, air conditioning, etc.

Step 1: Plug the blue end of the battery clamps into the socket on the jump starter.

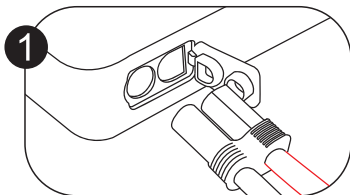

Step 2: Connect the other end of the battery clamps to the vehicle battery. Red clamp to positive polarity(+), black clamp to negative polarity(-).

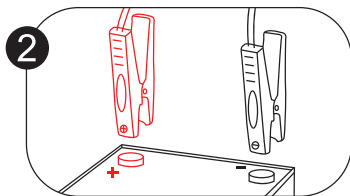

Step 3: Try starting the vehicle. Most vehicles will immediately start. Some vehicles may require the JS001 to be connected for up to 30 seconds before starting. If the vehicle does not start right away, wait 20-30 seconds and try again. Do not attempt more than five 5 consecutive jump starts within a fifteen 15-minute period. Allow the JS001 to rest for fifteen (15) minutes before attempting to jump-start the vehicle again.

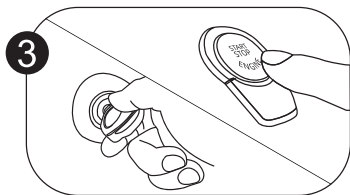

Step 4: After successfully cranking the vehicle, remove the clamps from the batteries and separate the clamps and jump starter.

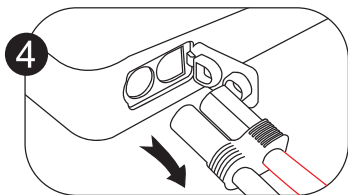

How to charge digital products?

This jump starter is able to be used as a power bank. Press the Power Button once to turn on the JS001. Then you can quickly charge your phone or tablet through the USB Out port, and quickly charge your laptop through the Type-C Out port.

Step 1: Plug the USB port of the charging cable into the product USB interface.

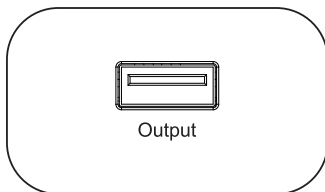

Step1

Step 2: Insert the other end of the charging cable into the corresponding charging port of the mobile phone or digital device.

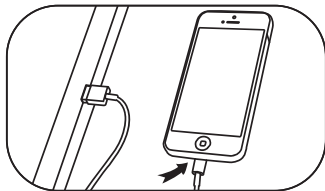

Step2

Step 3: Press the "Power" button to turn on the power, and the USB power supply can be started.

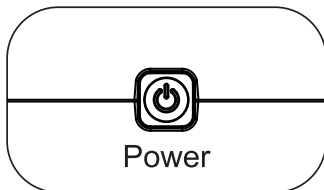

Step3

*The machine has an output short-circuit protection function: the output is automatically turned off when short-circuited(after the fault is removed, it needs to be restored by pressing the button or activated by charging)

Basic Parameters

Model	JS001
Capacity	59.2Wh
Input/Output	5V \rightleftharpoons 3A
Output 1	5V \rightleftharpoons 3A, 9V \rightleftharpoons 2A, 12V \rightleftharpoons 1.5A
Output 2	5V \rightleftharpoons 2.1A
Lifespan	1000 times
Operating Temperature	-10~50°C

How to use the lighting function?

Press “” (“LED light” button) to turn on the high lighting mode. Short press again, in turn, to switch to low lighting mode, SOS mode, strobe mode, and warning light mode.

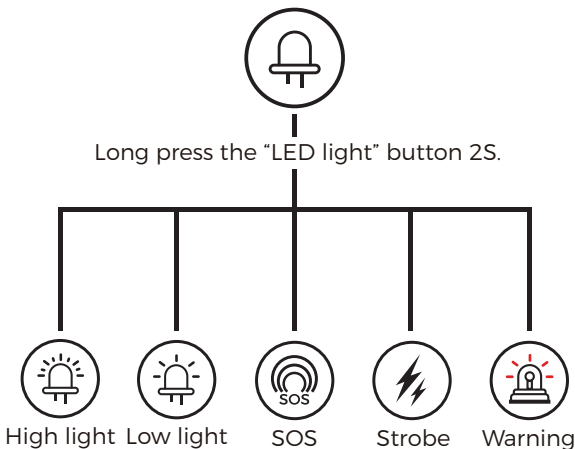

Long press “” (power button) for 2 seconds in any mode to turn off the LED lamp function.

Folding lamp function display

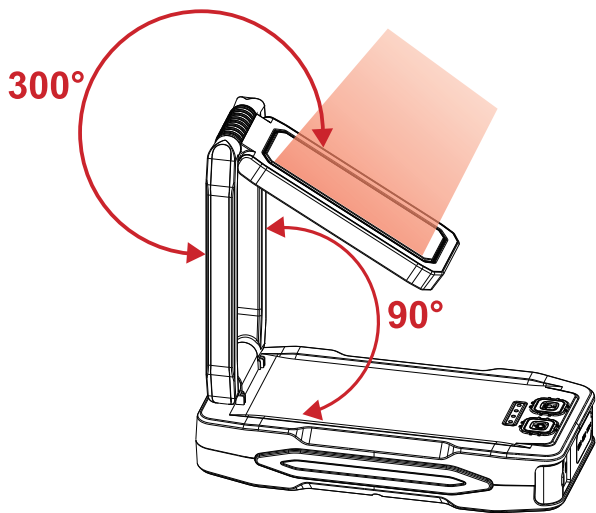

Please read the following instructions carefully before using the multi-function vehicle emergency starter:

1. Please strictly follow the instruction manual to operate. If used improperly or against the instructions, it may cause a serious safety incident.
2. Only for starting a 12V engine and can not start vehicles exceeding specified displacement or voltage.
3. In order to prolong the life of the battery, please charge the device after purchase, and charge and discharge the device every three months to ensure that it is in good condition for the next use.
4. Do not use a jump starter that has been severely hit, dropped, or other damaged.
5. Please do not disassemble the jump starter without authorization. Please contact professional maintenance personnel for repairing the jump starter.
6. When the jump starter is charging, do not use it to start the vehicle.
7. Be extra cautious during operation to avoid metal tools falling on the jump starter interface (it is easy to cause a short circuit, equipment damage, or an explosion).
8. When using the jump starter, ensure that the surrounding area is well-ventilated.
9. When starting the vehicle, make sure that the positive and negative contact points on the cable clamp of the jump starter are in good contact with the positive and negative poles of the battery.
10. Sparks and flames contacting the jump starter and engine is forbidden.
11. In order to prevent sparks from short-circuiting and

damaging the jump starter it is forbidden to clamp the positive and negative poles of the clamp together or touch the same metal.

12. Do not place the jump starter where children can reach it.
13. Do not expose the jump starter to rain or snow.
14. Do not leave the device in extreme environments for a long time (high temperature: above 122F(50C), extreme cold: below 1F(-10C), humid: humidity>80%).
15. Please store the jump starter in a cool and dry place, and take protective measures if necessary.
16. Please charge the product in time to prevent battery low-voltage or out of power. Long time the power status of the battery may cause the product to fail to charge.

There is no user-serviceable part of the equipment, do not disassemble the start-up power supply without permission, any maintenance should be handled by professional maintenance personnel.

Cautions:

1. This product can be used to start a 12V battery engine, but cannot be used to start a 24V battery engine.
2. When the battery capacity is greater than 50%, it can be used to start the vehicle quickly. Insufficient power may not be able to effectively start the vehicle.
3. Some heating of the body is normal after the jump starter started.
4. In order to maximize the life of the built-in battery, please charge the jump starter at least once every 3 months.
5. If the jump starter leaks or emits any odor, please stop using it and contact us immediately.
6. If a startup fails, please try again after at least 1 minute to avoid damage to the product.
7. After starting the car, please wait at least 30 minutes before charging the product.
8. Please do not connect the red clamp to the black clamp, which may cause danger.
9. Please use only the original ignition clamps.
10. Keep away from fire and water sources to avoid causing safety accidents.
11. Do not expose the jump starter to temperatures above 122°F(50°C) or to sunlight. Store the jump starter in a cool, dry place.
12. Do not disassemble or modify the product without

approved authorization.

13. Do not hit, press, or shake the jump starter, otherwise, it may cause fire, explosion, and burning.
14. Do not use chemical cleaning agents to clean the jump starter.
15. This product is not a toy, and it is forbidden for children to use it. It is recommended for users over 16 years of age.

Every BIZEWO jump stater has a 90-day money-back guarantee and a full two-year warranty. If quality problems happen in guarantee period, our company will replace it for free. Additionally, our company provides technical support. After-sales service isn't restricted by time and we will assign technical personnel to solve your problems immediately after receiving the telephone or hearing feedback ideas from you and deal with them in time. If you are caught in some problems when using our products, welcome to contact us at any time.

DISPOSAL

The appliance should not be disposed off via the household bin collection. Disposal of the appliance should be carried out in accordance with the national regulations. If electrical appliances are disposed of in landfills or dumps, hazardous substances can leak into the groundwater and get into the food chain, damaging your health and well-being. When replacing old appliances with new ones, the retailer is legally obligated to take back your old appliance for disposal.





BIZWO



www.bizwohome.com



support@bizwohome.com



1-888-283-6836



Made in China